

# HT PP VNITŘNÍ ODPADNÍ SYSTÉM

HT PP INTERNAL DRAINAGE SYSTEM | HT PP HAUSABFLUSSSYSTEM | HT PP ВНУТРЕННЯЯ КАНАЛИЗАЦИЯ

## HTM Zátka

Plug  
Muffenstopfen  
Пробки

| ART.    | DN  | L  | balení ks |
|---------|-----|----|-----------|
| CZ30000 | 32  | 32 | 20        |
| CZ40000 | 40  | 24 | 50        |
| CZ50000 | 50  | 30 | 50        |
| CZ70000 | 75  | 36 | 20        |
| CZA0000 | 110 | 40 | 30        |
| CZC0000 | 125 | 50 | 20/1      |

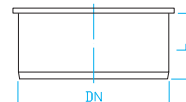

## HTRE Čistící kus

Access pipe  
Reinigungsrohr  
Ревизия

| ART.    | DN  | L   | balení ks |
|---------|-----|-----|-----------|
| CC50000 | 50  | 146 | 20/1      |
| CC70000 | 75  | 192 | 20        |
| CCA0000 | 110 | 228 | 16        |
| CCC0000 | 125 | 236 | 20/1      |

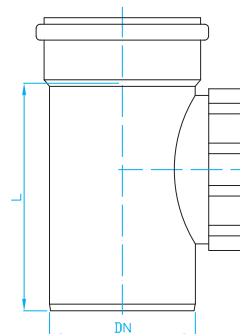

## HTU Nátrubek

Slip coupling  
Überschiebemuffe  
Патрубки

| ART.    | DN  | L   | balení ks |
|---------|-----|-----|-----------|
| CN30000 | 32  | 84  | 20        |
| CN40000 | 40  | 100 | 35        |
| CN50000 | 50  | 106 | 25        |
| CN70000 | 75  | 144 | 20        |
| CNA0000 | 110 | 170 | 30        |
| CNC0000 | 125 | 177 | 20/1      |

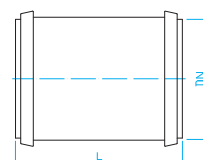

## HTMM Spojka dvouhrdlá

Double socket  
Doppelmuffe  
Патрубки

| ART.    | DN  | L   | l  | balení ks |
|---------|-----|-----|----|-----------|
| CS40000 | 40  | 100 | 2  | 35        |
| CS50000 | 50  | 106 | 3  | 25        |
| CS70000 | 75  | 144 | 22 | 20        |
| CSA0000 | 110 | 170 | 26 | 15        |
| CSC0000 | 125 | 177 | 27 | 20/1      |

